

Level-Angle Meter A80 Instruction Manual

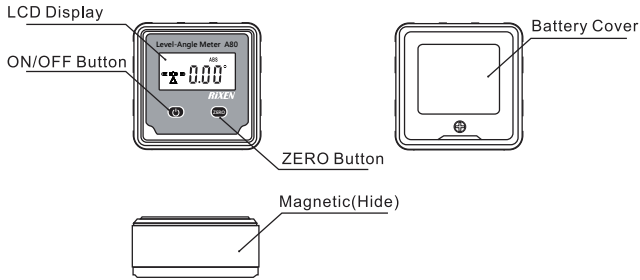

A80 Technical Specifications	
Accuracy	0°~90° : ± 0.1°, the rest : ±0.2
Resolution	0.05°
Working Range	90°×4
Power Supply	AAA alkaline battery×2
Working Temperature	-5~+45°C (23~113°F)
Working Humidity	≤85%RH

Screen Icons	
ABS	Indicates that the instrument is working in absolute angle mode
-1-	Indicates that the instrument is calibrating for one direction
-2-	Indicates that the instrument is calibrating for another direction
Erro	Warning of the vertical axis deviation

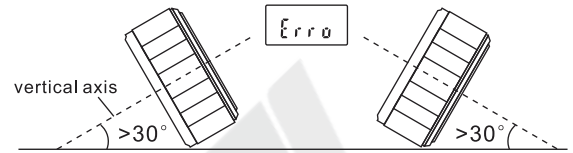

Button Function

1. Press the button once to turn the unit on. To turn off the unit, hold the button for 3 seconds, After not pressing any button for about 5 minutes, the device will automatically shut down.

ZERO (1) With the device turned on, press the **ZERO** button to set the display to zero and enter the relative measurement mode. (Set the current measurement position to "zero")
 (2) In the relative measurement mode, the "ABS" symbol on the LCD will disappear.
 (3) The relative measurement mode allows the operation to measure the difference between two objects.
 (4) To return to (ABS) absolute measurement mode, press the **ZERO** button once.
 ※Please refer to the picture below

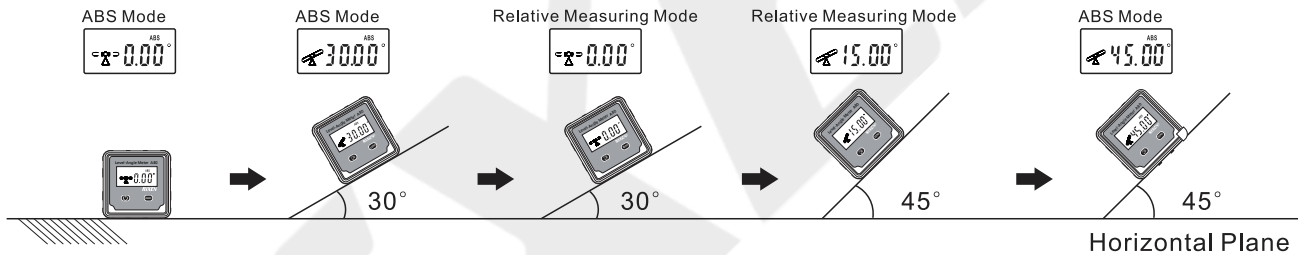

Calibration

The instrument has been calibrated before leaving the factory, so there is no need to calibrate or adjust it before use.

* If the measurement error is too large due to drop, impact, maintenance or other factors.....you must Perform recalibration.

- Place the instrument on a stable plane as flat and smooth as possible, press and **ZERO** two keys at the same time to start the calibration mode, and display "-1-".
- When "-1-" is displayed, press the key, and "-1-" will flash briefly. This is the first stage of calibration. After completion, it will automatically display "-2-".

* Note: When "-1-" flashes briefly, do not move the instrument until "-2-" appears.

- After completing the above item (2), turn to the same position and rotate 180° in place, then press the key, "-2-" will flash briefly, and the second stage of correction has been performed.
- In the state of (3) above, do not move the instrument until "-2-" disappears, and the current measured value is displayed to complete the calibration.

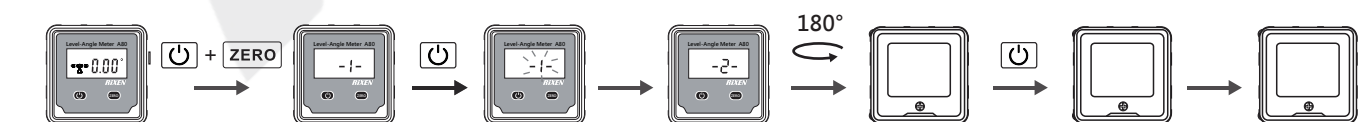

Icon Function

Symbol showing how to adjust the surface to be leveled

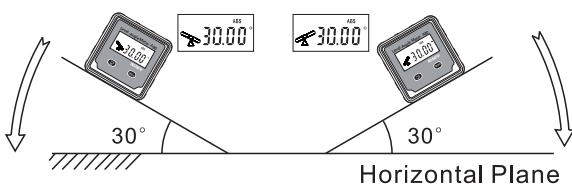

Battery Installation

- Turn off the power of the instrument.
- Use a small screwdriver to remove the battery cover. (Removing the screw will temporarily attract the bottom surface of the instrument to prevent loss.)
- Follow instructions to install two new batteries.
- Replace the battery cover.
- Please comply with local battery recycling regulations.

Note: When storing the instrument for a long time, make sure to remove the battery from the instrument.

A80 水平角度儀 操作手冊

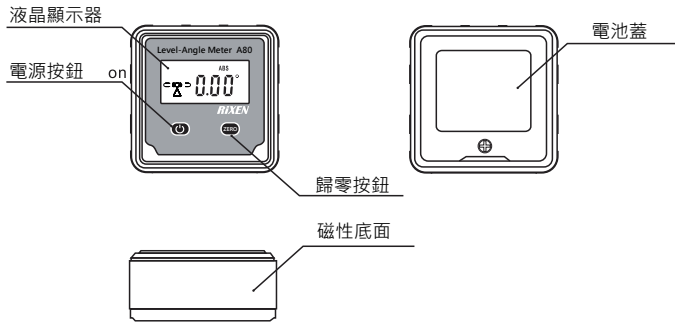

技術規格	
精確度	0°~90° : ±0.1° · 其餘 : ±0.2°
解析度	0.05°
操作範圍	90°×4面
電源供應	AAA 鹼性電池×2只
操作環境溫度	-5~+45°C (23~113°F)
操作環境濕度	≤85%RH

液晶螢幕代號	
ABS	表示水平角度儀在絕對角度模式下工作
-1-	表示水平角度儀正在校準一個方向
-2-	表示水平角度儀正在校準第二個方向
Erro	錯誤、垂直軸偏差警告 (如右圖所示)

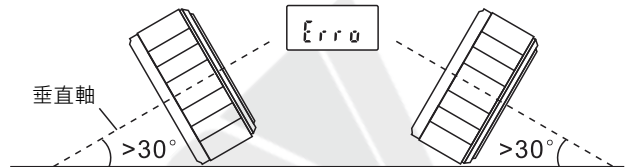

按鈕功能

- Power** 1. 按下此電源按鈕開啟儀器電源。要關閉本機，請按住此電源按鈕3秒鐘直到顯示幕關閉。約5分鐘未按任何按鈕後，儀器將自動關閉。

- ZERO** (1) 在儀器開啟的情況下，按此歸零按鈕將顯示為零並進入相對測量模式。(將目前測量位置設定為“零”)
 (2) 在相對測量模式下，LCD上的“ABS”符號將消失。
 (3) 相對測量模式允許操作測量兩個物面之間的差異。(參見下圖)
 (4) 要返回 (ABS) 絕對測量模式，請按一下 **ZERO** 鍵。

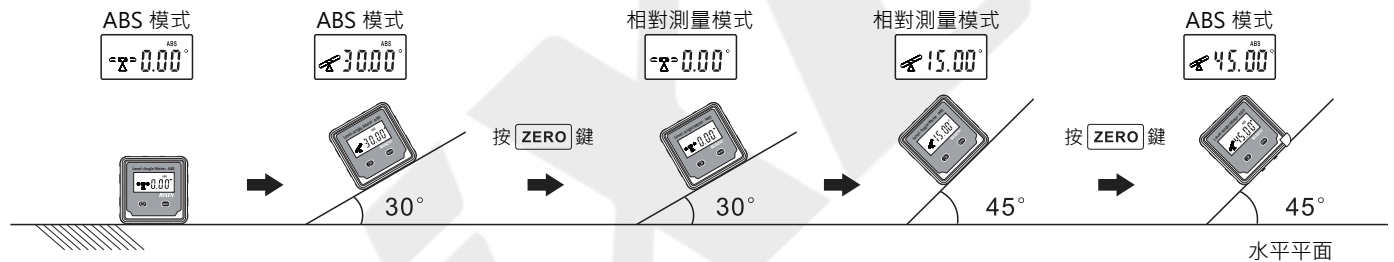

校正 (如下圖)

- *數字水平角度儀於出廠前已經進行校準，不需在使用前校正或調整。
 *如果儀器因不慎掉落、衝擊或維修及其他因素造成測量誤差過大時，即必須執行重新校正。
 (1) 將數字水平角度儀放置盡量平坦、光滑的穩定平面上，同時按壓 **Power** 與 **ZERO** 兩鍵、啟動校正模式，顯示“-1-”。
 (2) 於顯示“-1-”時，按壓 **Power** 鍵，“-1-”將短暫閃爍，此為執行第一階段之校正中，完成後將自動顯示“-2-”。
 *注意：當“-1-”短暫閃爍時，不可移動儀器，直到出現“-2-”為止。
 (3) 完成上述(2)項後，將遺棄於相同位置上原地旋轉180°，然後按壓 **Power** 鍵，“-2-”將短暫閃爍，以進行第二階段之校正。
 (4) 於上述(3)的狀態下，請勿移動儀器，直到“-2-”消失，並顯示目前的測量數值，即完成校正。
 *注意：上述(4)校正完成後的顯示讀值，是該校正平面和水平面之間的角度值。

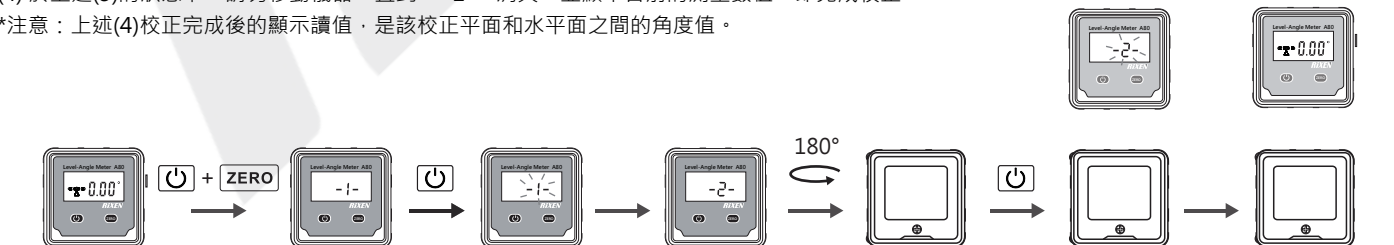

水平(角度)示意圖示

符號 “ ” 指示如何調整水平(角度)的方向。

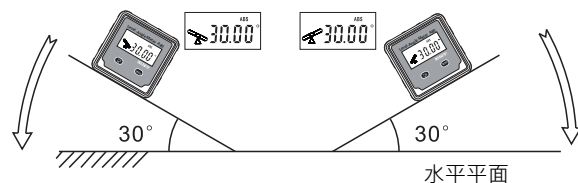

電池安裝

1. 確實關閉儀器電源。
 2. 使用小型十字起子取下電池蓋。
(可將卸下之螺絲暫時吸附於儀器底面之磁性板上，以防止遺失。)
 3. 按照 ⊕ ⊖ 極性指示安裝新電池。
 4. 裝回電池蓋。
 5. 請遵守您當地之電池回收之規定。
- 注意：長期存放儀器之前，請務必取出電池。